

BATTLIN'
BULLDOGS



FRESNO STATE
BULLDOG



GO PRIDE OF THE VALLEY
'DOGS!

RED WAVE
RISE UP!

FOUNDATION

ANYONE,
ANYTIME,
ANYWHERE!



UNDERDOGS
TO WONDERDOGS!



1950

75TH

2025

Bulldogs

BULLDOG
BORN,
BULLDOG
BRED.
GONNA
BE A
BULLDOG
'TIL THE DAY
I'M DEAD



ANNIVERSARY

2025 BULLDOG FOUNDATION MEMBERSHIP GUIDE

TABLE OF CONTENTS

2	WHY GIVE?
3	WHERE YOUR CONTRIBUTION GOES
4	BULLDOG FOUNDATION 75TH ANNIVERSARY
5	CLUB RED
6	MEYERS CHAMPIONS CIRCLE
8	THE GREEN V SOCIETY
10	PAC-12
12	FOOTBALL TICKETS AND PARKING
14	MEN'S BASKETBALL TICKETS
15	BENEFITS CHART
16	PRIORITY POINTS
17	MEET OUR TEAM

TIMELINE

FEBRUARY

- Renewal Season Begins

APRIL

- Renewal Season Ends

MAY

- New Seat Requests Processed for Football

JUNE

- Football Parking Assignments & Basketball Pledges Renewed

JULY

- Football All Seating Open & Basketball New Seat Requests Processed

AUGUST

- Football Tickets Delivered & Final Payment
- Basketball Ticket Renewals Sent Out
- Football Kick-Off

OCTOBER

- Basketball Tickets Delivered

NOVEMBER

- Basketball Tip-Off





Dear Bulldog Foundation Members,

As I reflect on my first six months as your Director of Athletics, I am both humbled and energized by the incredible passion and commitment of the Red Wave. This fall season has shown me what makes Fresno State—and the Valley—so special: a community that rallies behind its student-athletes with unmatched pride and support.

A New and Exciting Era in Bulldog Football

The future of Fresno State Football is brighter than ever as we usher in a new era under the leadership of Coach Matt Entz. Matt and his family have already embraced the Valley, and he is working tirelessly to build a coaching staff and a team that will honor our proud traditions while striving for new heights. His championship pedigree and values align perfectly with what it means to be a Bulldog. I can't wait to see the program take the field and make us all proud as we begin this exciting journey together.

Your Impact: A Record-Breaking Year for the BDF

Thanks to your generosity and belief in Fresno State Athletics, the Bulldog Foundation achieved a record year in fundraising. You've helped us invest in our student-athletes' academic success, health and well-being, and competitive growth. On behalf of our entire department, thank you.

That said, as we prepare to join the **Pac-12 Conference**, our work is just beginning. While we are celebrating a banner year, we will enter the Pac-12 as one of the least resourced programs in the conference. Competing at this level requires us to keep growing and evolving. The Bulldogs need all of us to step up and close the gap, ensuring our student-athletes have every opportunity to succeed on the biggest stages.

A Changing Landscape in College Athletics

College athletics is changing at a rapid pace. New challenges—like revenue sharing, Name, Image, and Likeness (NIL), the Transfer Portal, and legal cases like House v. NCAA—require us to think differently and adapt quickly. We cannot tackle these challenges alone. Now, more than ever, we need the unwavering support of our Bulldog community to remain competitive and resilient in this evolving landscape.

What We've Accomplished Together

In just four months, we've made bold strides that signal a promising future for Fresno State Athletics:

- Securing our place in the **Pac-12 Conference**, a transformational move for the university and the Valley.
- Welcoming Matt Entz to lead Bulldog Football into a new era of success.
- Seeing record-breaking attendance across our venues, a testament to your pride and passion.

While we celebrate these achievements, we know the work ahead is critical.

Looking Ahead: A Call to Action

Our future will be defined by the choices we make today. Our goals are clear:

- To set new records in fundraising, ensuring our programs are resourced to compete and win.
- To develop a strategic plan that will guide Fresno State Athletics with measurable goals and accountability.
- To position Bulldog Football, and all of our programs, for long-term success, knowing the next few years will define our trajectory in the Pac-12 and beyond.

None of this is possible without you. Every contribution—large or small—makes a difference. Your support fuels scholarships, improves facilities, enhances the student-athlete experience, and drives the success of Fresno State Athletics. Together, we will rise to meet the challenges ahead and position our Bulldogs for greatness.

Thank you for your dedication to Fresno State and for believing in what we can achieve—together. Let's make this year even more impactful.

GO 'DOGS!

Garrett Klassy

Director of Athletics, Fresno State



WHY GIVE?

3.35 Cumulative GPA
for the School Year

**Top 3
Majors**

1. Business
2. Kinesiology
3. Communication

83 Graduates

250 Academic All-Conference
Athletes

308 Student-Athletes receiving
Athletic Scholarships

84 Student-Athletes
on Full Scholarship



A handwritten signature in black ink that reads "Tyler Mariucci".

Tyler Mariucci
Senior Associate Athletics Director
for Development

"Last year's record-breaking fundraising year is a testament to the long-standing support from our Bulldog Foundation members, who have been committed for the last 75 years to helping young people excel in the classroom, in competition, and in life! Thank you from all of us here at Fresno State Athletics."



WHERE YOUR CONTRIBUTION GOES

Creating championship experiences for Bulldog student-athletes begins with funding scholarships. With 18 sports, 308 students receiving athletic aid and the increasing annual cost of attendance, the challenge to raise the needed scholarship dollars is greater than ever. Every contribution made helps us close the gap between what we raise each year and the total cost of scholarships.

Every dollar given makes an impact towards our mission.

Breakdown of a Full Scholarship

CALIFORNIA RESIDENT

Tuition and Fees	\$6,973
Books	\$800
Room and Board/Personal Expenses	\$16,994
Total Cost of Attendance	\$24,767

Breakdown of a Full Scholarship

OUT OF STATE/INTERNATIONAL

Tuition and Fees	\$18,853
Books	\$800
Room and Board/Personal Expenses	\$16,994
Total Cost of Attendance	\$36,647

Estimated 2025 Total Cost of Scholarships

\$8 Million

BULLDOG FOUNDATION



THE TEAM
BEHIND
THE TEAMS

FRESNO STATE



THE BULLDOG FOUNDATION

BEYOND THE GAME

CELEBRATING 75 YEARS OF EXCELLENCE

In 2025, the Bulldog Foundation proudly celebrates a monumental milestone, the 75th Platinum Jubilee Anniversary of being “the team behind the teams.” For three-quarters of a century, the foundation has played a pivotal role in fostering the success, growth, and legacy of Fresno State Athletics, propelling student-athletes toward excellence in the classroom, in competition, and in life.

Founded in 1950, the Bulldog Foundation was established to provide essential financial support to the athletic programs for Fresno State student-athletes. Over the years, this vision has flourished, becoming a necessary piece of the university’s athletic department. The foundation has grown from a scholarship fund into a multifaceted resource through capital projects, endowments, sport-specific support, and legacy-planned gifts, giving Bulldog athletic teams what is needed to compete at the nation’s highest level.

All of this has been achieved by the goodwill and generosity of its donors, alumni, the Red Wave, and all fans of the Central Valley. Please join us in celebrating 75 years of memories, accomplishments, and championships. As the Bulldog Foundation looks forward to the next 25 years and our 100th Jubilee anniversary, we will continue our commitment to developing student-athletes, ensuring they leave Fresno State as champions and future leaders in their respective fields.

CLUB RED

Club Red is a prestigious and exclusive group for former Bulldog student-athletes, coaches and trainers. Club Red is a one-of-a-kind community, bound forever by the Bulldog experience and dedicated to promoting the ever growing legacy of Fresno State Athletics. With 250+ members and counting, Club Red continues to represent Bulldog Born, Bulldog Bred throughout the years.



MEMBERSHIP INCLUDES:

- Up to four (4) discounted football/men's basketball season tickets
- Option to request two (2) All-Sports Passes for access to regular season Fresno State home events (excluding Football and Men's Basketball)
- Two (2) admissions to BDF Club Red tailgates



CLUB RED IN 2024

256
Members



Donated
\$372,106
for scholarships

Provided
14.88
full scholarships for
Bulldog student-athletes

*\$100+ Club Red Members
receive associated BDF
Membership Benefits*



MARVIN AND TISH MEYERS CHAMPIONS CIRCLE

The “Meyers Champions Circle” is an exclusive philanthropic giving society designed to maximize the resources for Bulldog student-athletes and improve the landscape of Fresno State Athletics. The Meyers Champions Circle is designed to honor donors whose major gift commitments rise above and beyond their annual giving requirements for seats and parking.

Membership in the Meyers Champions Circle requires a philanthropic “major gift” of \$25,000 or more paid within a five-year period. These gifts can be directed to Capital Projects, Endowments, or Specific Sports.

To learn more about the Meyers Champions Circle or other opportunities to impact Fresno State student-athletes, please contact the Bulldog Foundation at 559.278.7160 or visit bulldogfoundation.org.



Student-athletes received their graduation stoles at the 2024 Donor Appreciation Dinner.

2024-25 CHAMPIONS CIRCLE MEMBERS

Chris Morse & Ken Wittwer
Morse Witter Sport Performance
Center

Ken Wittwer & Chris Morse
Men's Basketball FFE

Jeanne Contel
Endowed Softball Scholarship

Sue Hedman
Endowed Women's Basketball
Scholarship

Ric & Annie Avila Schultz
Endowed Volleyball Scholarship

Tom & Davita Miller
Endowed Scholarship

Carla Millar
Endowed Baseball & Softball
Scholarships

Spike & Marjorie Biggers
Endowed Track & Field
Scholarship

Julie Kerkochian
Endowed Female Student-Athlete
Scholarship

Linda Duncan
Endowed Football Scholarship

Scott & Jody Barnes
Endowed Women's Track & Field
Scholarship

Vin Whelan Family
Football Fund for Excellence

The Irwin Family
Endowment Fund

James & Donna Caldwell
Men's Basketball Fund for
Excellence

Crosby Family Charitable Trust
Scholarship Fund & Sports
Medicine

Valley Unique Electric
Football Fund for Excellence

Carl & Barbara Ueland
Scholarship Fund & Capital
Projects

Helen Gigliotti
Endowed Softball Scholarship

Jim, Jeannette & Jason Martin
Endowed Softball Scholarship

Brandon & Nicole Eachus
Men's Basketball Fund for
Excellence

Diamond Learning Center Inc
Endowed Baseball, Football,
Women's Basketball, Track & Field
Scholarships

Hogi & Dallas Selling
Football Fund for Excellence

A J De Jager
Football Fund for Excellence

**Blair, Church & Flynn Consulting
Engineers**
Endowed Female Student-Athlete
Scholarship

Steven Moore
Scholarship Fund

Spencer Enterprises Inc
Scholarship Fund & Capital
Projects

Eric & Darlene Hanson
Capitol Projects

Barry & Peggy Maas
Capital Projects

Panoche Creek Packing
Capitol Projects

Ben & Carla Carroll
Capitol Projects

Frank & Stacy Roque
Scholarship Fund & Capitol
Projects

Pete & Caroline Simis
Endowed Bulldog Built Scholarship

Tami Lundberg
Endowed Women's Basketball
Scholarship

Chris & Kelly Woods
Endowed Bulldog Built Scholarship

Richard & Bonda Aranas
Endowed Women's Basketball
& Volleyball Scholarship

Jim G. Palmer
Endowed Football Scholarship

**Katelyn Spencer & Colleen
O'Brien**
Endowed Spirit Squad Scholarship

Brad Heier
Football Fund for Excellence

Gerald & Julia Chow
Nutrition

Chuck Bandelian
Men's Basketball Fund for
Excellence

Tony Petrosino
Endowed Women's Tennis
Scholarship

Bessinger Family
Football Fund for Excellence

Curtis Lovett
Scholarship Fund

JoAnn Stodden
Endowed Equestrian Scholarship

Ed Hughes Family
Endowed Football Scholarship

Ed & Jean Lane
Endowed Football & Men's
Basketball Scholarship

US Bank
Endowed Bulldog Built
Scholarship

John Sirman
Endowed Men's
Golf Scholarship



GREEN V SOCIETY

Bulldog student-athletes, coaches, and athletics staff proudly wear the “Green V” to show their pride in representing the San Joaquin Valley.

The “Green V” Society represents a dedicated and committed group of Fresno State Athletics donors who contribute \$10,000 or more in annual scholarship support. This ensures that Bulldog student-athletes are equipped to be successful in the classroom, in competition, and life.



2024-25 GREEN V SOCIETY MEMBERS

Hall of Fame \$50,000 and Above

Community Health System
Thiesen Dueker Group
Precision Civil Engineering
Fresno First Bank

President \$25,000 - \$49,999

Steven Moore
Carl & Barbara Ueland
James G. Parker Ins Assoc
Valley Unique Electric
Eric C Hanson MD
Crosby Family Charitable Trust
The Tatham Family
Frank & Stacy Roque

First Team \$17,000 - \$24,999

P R Farms
Brandon & Nicole Eachus
Fresno Valves & Casting
Jeannette Martin
Charles McMurray Co
Schultz Family

Director \$10,000 - \$16,999

Henry Hinkle
Rock'N J K Farms
Walter R Reinhardt Ins Agency
John & Jodie Thomas

Spano Enterprises
Barry Maas
DiBuduo Fruit Co
CV Truss Inc
Darryl & Darin Zuber
Ashwood Construction
Richard Conway
Jeff & Sharon Segars
Melvin Pereira
Rebecca Kaser
Fashion Furniture
Lawrence Phillips
Sheri McBee
Janie & John Garcia
Kitahara Foundation
Gene & Elizabeth Berberia
Jerry Beckstead
W Troy Collins
Diamond Learning Center Inc
Ron & Lisa Colburn
James & Donna Caldwell
Kings River Packing LP
San Joaquin Glass
Mike & Sue Martinusen
High Performance Academy
Breadcrumb Cybersecurity
Allenberg Cotton Co
John Burns Co
FACSCO
Harry Gaykian
H Markus & Margossian Printing
Jim Winton
Target Constructors Inc
Mary Castro-Ayala

Diebert & Associates, CPAs
Clawson Honda
Kathy Huebert
Valley Air & Repair
Christian Ueland
Dario Calderon
Jace & Margaret Baird
Caddis Properties LLC
EKC Enterprises
R J O Produce Marketing
Tom Tsaris
Quinn Company
Caleb & Desiree Haus
Ruiz Foods
PDS
Beck Ruiz
Ali Tousi
Heavy Road Ind
T G Schmeiser Co Inc
Ammonia Refrigeration Services
Smittcamp Enterprises
Keeley & Judith Bramer
Spencer Enterprises Inc
Richard & Joan Ahronian
Van Beurden Insurance Services
Valley Iron Inc
Cort Walberg
Gary & Kim Chahil
Mid Valley Services Inc
B-K Lighting
David Britz
Fowler Packing Co
J & M Britton
Table Mountain Rancheria

Wathen Castanos Inc
Trinity Fruit Sales
San Joaquin Stairs Inc
Mark Turmon
E M Tharp Inc
Rod & Clarice Scarry
Dant Morris
Community West Bank
Vin Whelan Family
Dan Bushey
Gina Cuttone
Red Triangle Oil
Sagaser Watkins & Wieland Pc
DiBuduo & DeFendis Inc
S-K Ranch
Fitzgerald, Alvarez & Ciummo
Caglia Environmental
Snowden Enterprises Inc
Taylor Bros Inc
Mike Harris
John Bonadelle Jr
Reynolds Ins Services Inc
Gerald Forrest Family
Builders Flooring Inc/Moskowitz Electric
Brett Visintainer
Danette Hall
Nate Miller
Chris & Stacy Pacheco



x



ASCENSION **TO THE PAC-12**

A historic and transformative moment for Fresno State Athletics is on the horizon. As many know, our inclusion into the prestigious Pac-12 Conference is a monumental step for our athletic programs. It begins a new era for our student-athletes, coaches, and the Red Wave. This results from hard work, dedication, a relentless attitude, and a shared vision for success that has spanned generations of Bulldog student-athletes.

The Pac-12 Conference possesses a rich history of athletic prowess, and prestigious academics, which gives student-athletes an unrivaled opportunity to become the best version of themselves on and off the field of competition. Joining this prestigious conference will ascend Fresno State Athletics to new heights, continue providing a world-class education for student-athletes, and an opportunity to represent the Central Valley nationwide.

As we prepare for our inaugural Pac-12 season in 2026, we need the continued support of the Red Wave to ensure that our athletic programs have the resources to succeed at a high level. Whether you are a current Bulldog Foundation member, a new or former supporter, or someone looking to get involved for the first time, your contribution, of any level, will create and make an immediate and lasting impact on Fresno State Athletics.

**RED WAVE
RISE UP!**

FOOTBALL

Minimum Per Seat Scholarship Contribution

Scholarship Contribution

Ticket Cost

\$500	■	*Level 1	\$306
\$350	■	*Level 2	\$306
\$250	■	*Level 3	\$306
\$100	■	Level 4	\$229
\$200	■	Level 5	\$229
\$150	■	Level 6	\$229
\$100	■	Level 7	\$229
\$50	■	Level 14	\$229

*New seats assigned in 2025 for sections 9-13 require the following minimum contribution per seat for consideration: 9 and 13 (\$350), 10 and 12 (\$500), 11 (\$1,000).

THE AMOUNTS INDICATE THE MINIMUM annual per seat support necessary in each section. Meeting the minimum amount DOES NOT GUARANTEE NEW seating in a particular section. Seat changes and additional/new season tickets, are assigned based on availability and all requests are filled on a Priority Point basis.

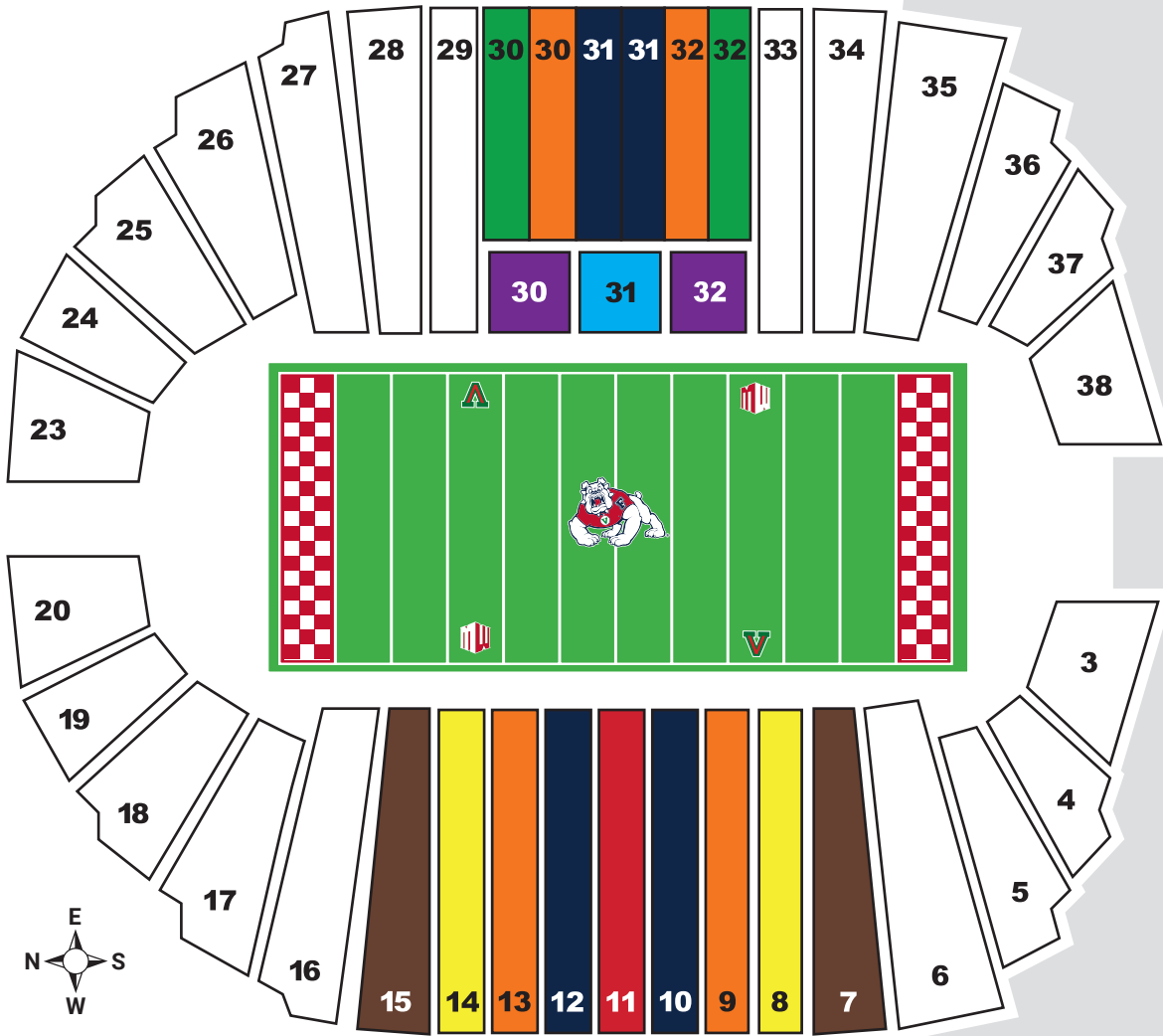

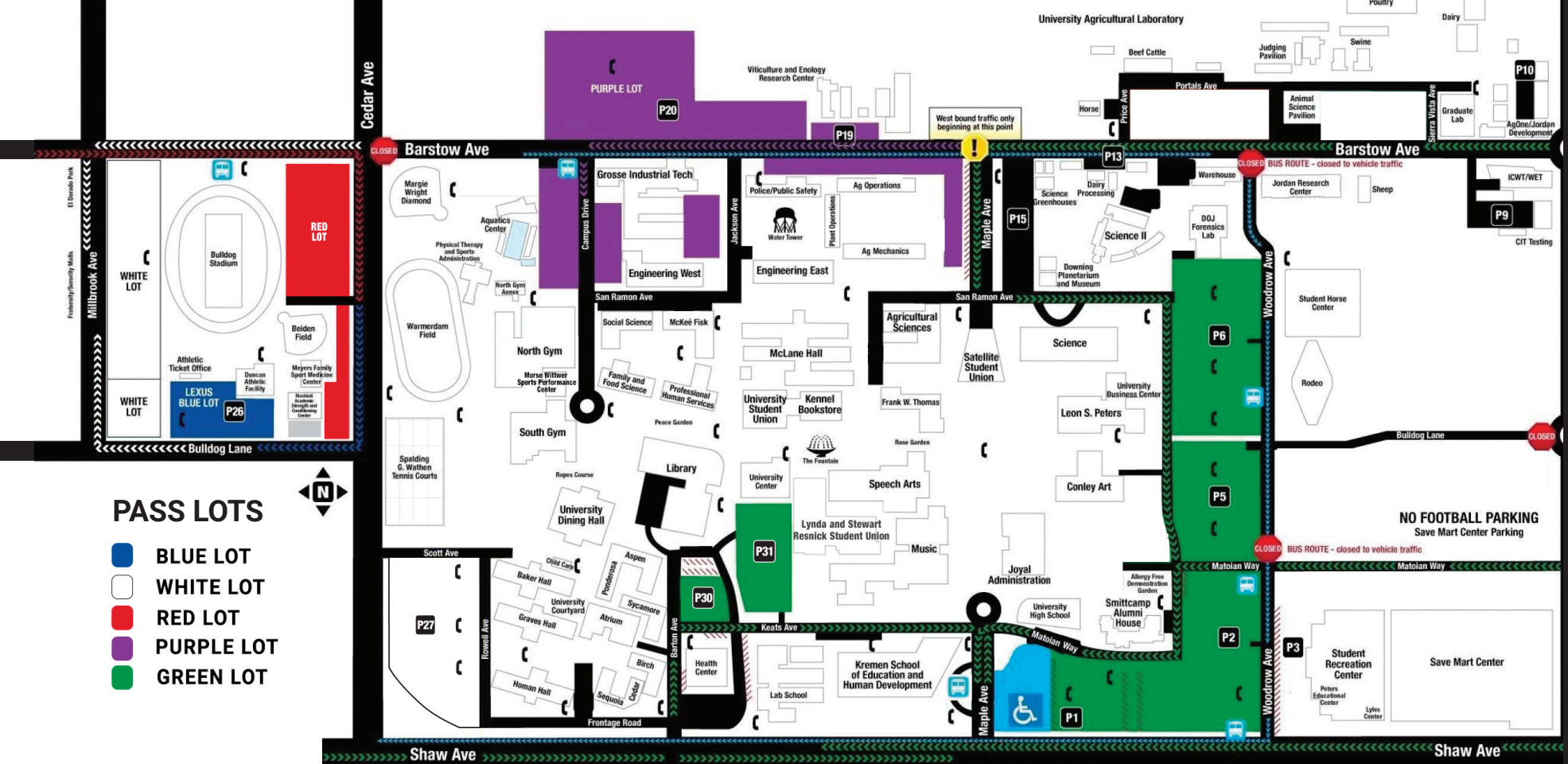

PARKING CONTRIBUTION REQUIREMENTS

For new pass consideration, these minimum Bulldog Scholarship Fund contributions must be made:

Parking Lot	Minimum Donation	Season Pass Cost
Picnic Red/White/Blue	\$10,000	\$600
Auto Red/White	\$5,000	\$120
Auto Purple	\$500	\$120
Auto Green	\$100	\$20

Season picnic spaces include two passes for parking within the space.

PARKING RENEWALS

Red, White and Blue lot auto and picnic pass holders must maintain their minimum required contribution to guarantee their same parking for 2025.

MEN'S BASKETBALL

Minimum Per Seat Scholarship Contribution

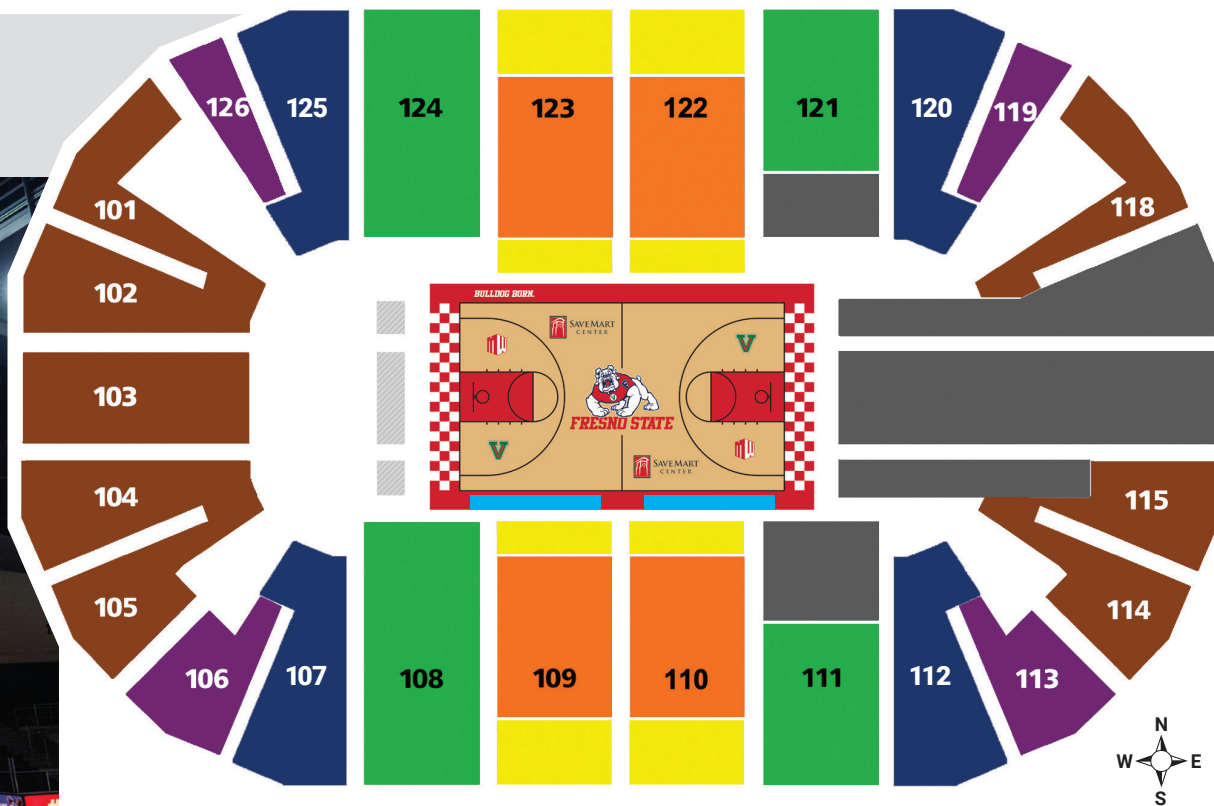

Scholarship Contribution

Ticket Cost

\$2,500 ■ Courtside* **\$410**

\$500 ■ Level 2 **\$410**

\$500 ■ Level 3 **\$280**

Scholarship Contribution

Ticket Cost

\$250 ■ Level 4 **\$199**

\$100 ■ Level 5 **\$199**

\$50 ■ Level 6 **\$199**

\$50 ■ Level 7 **\$99**

**Please contact the Bulldog Foundation for more information*

BENEFITS CHART



	Former Student-Athletes							Green V Society Levels				
	Club Red \$50	Red Wave \$100	Spirit \$250	Captain \$500	Champion \$1,000	Victory \$1,750	MVP \$2,500	All-American \$5,000	Director \$10,000	First Team \$17,000	President \$25,000	Hall of Fame \$50,000
Tax Deduction*	●	●	●	●	●	●	●	●	●	●	●	●
Online Recognition	●	●	●	●	●	●	●	●	●	●	●	●
Bulldog Brief E-News	●	●	●	●	●	●	●	●	●	●	●	●
Football Parking Access		●	●	●	●	●	●	●	●	●	●	●
Bulldog Plaque+				●	●	●	●	●	●	●	●	●
All Sports Admissions**						2	4	4	6	6	6	6
Special Event Invitations								●	●	●	●	●
VIP Football Parking Access									●	●	●	●
Green V Gift									●	●	●	●

*Any part of a Bulldog Scholarship Fund contribution that is required for seating is not tax deductible. Please consult your tax advisor for more information.

** Included with membership upon request. Valid for all paid sports except Football and Men's Basketball.

+Eligible after second year

If alterations are made to our program that affects benefits, the Bulldog Foundation reserves the right to make adjustments at that time.

PRIORITY POINTS



The Priority Point System recognizes Bulldog Foundation Members and is used to determine priority for season ticket and parking assignments, away game football tickets and post-season events including bowl games. Our goal is to equitably recognize support made through the Bulldog Foundation and to reward those who have helped Fresno State student-athletes.

Current Year Support

(5 points per \$100)

Scholarship Fund points are based on current year pledge and all non-scholarship points are based on payments received in the 12 months prior to point calculation.

Historical Giving (\$)

(2 points per \$100)

All Bulldog Foundation support from 1992 not included in Current Year category.

Football Suites

Points are awarded for total suite cost less ticket value in the Current Year Support and Historical Giving categories (dating back to 2005).

Historical Giving (Years)

(2 points per year)

Points are assigned based on consecutive years supporting the Scholarship Fund from current year back to 1992.

Season Tickets Purchased

(5 points per sport)

Current Year purchase in any sport.

Former Bulldog Student-Athlete

(50 points)

One-time points for letter winners.

Former Volunteers

(2 points per year)

Points per year of volunteering on BDF Fund Drive.

IMPORTANT NOTES

- Our records allow us to recognize support from 1992 to present. Member ranking is based on Priority Point total as long as all minimum support requirements for tickets and/or parking are met.
- Customers must have a current Red Wave (\$100) or higher membership in the Scholarship Fund to accumulate points.
- Priority Points are calculated prior to seating assignments and special events.
- Priority Points are non-transferable.
- If a member cancels their current Bulldog Foundation Membership they have no points. If they rejoin at a later date they receive all historical points for which they are eligible.

MEET OUR TEAM



Garrett Klassy
Director of Athletics



Tyler Mariucci
Senior Associate Athletics
Director for Development
559.278.8257
tylerm@mail.fresnostate.edu



Randy Rigali
Executive Director & Assistant
Athletics Director for Development
559.278.5442
rrigali@mail.fresnostate.edu



Ralston Compton II
Director of Development
559.278.1184
rcompton@mail.fresnostate.edu



Madelynn Garcia
Director of Alumni Relations
and Donor Engagement
559.278.2768
madelynn Garcia@mail.fresnostate.edu



Judy Lea
Assistant Director of Development,
Donor Relations and Events
559.278.4112
jalea@mail.fresnostate.edu



Thomas Orradre
Assistant Director of Development
559.278.1045
torradre@mail.fresnostate.edu



Patrick Ogle
Development Officer
559.278.6134
patricko@mail.fresnostate.edu



James Woolsey
Development Coordinator
559.278.3652
jameswoolsey@mail.fresnostate.edu

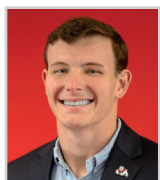

Andrew Thomton
Development Officer
559.278.8978
thomton@mail.fresnostate.edu



Ronell Moore
Accounting Specialist
559.278.6202
ronellmoore@mail.fresnostate.edu



April Sanchez
Administrative Support Coordinator
559.278.4317
aprilsanchez@mail.fresnostate.edu

Follow the Bulldogs

Sign up for Fresno State Vmails and follow [@fresnostatebdf](https://twitter.com/fresnostatebdf) for the latest information from the Bulldog Foundation.



P.O. Box 26267, Fresno, CA 93729

559.278.7160

bulldogfoundation@mail.fresnostate.edu

bulldogfoundation.org

BULLDOG FOUNDATION



P.O. Box 26267, Fresno, CA 93729 559.278.7160 bulldogfoundation@mail.fresnostate.edu

bulldogfoundation.org

Scan the QR Code to become a Bulldog Foundation member today!

